

Space plan 5th floor

CAT A +/- partially fitted



Reception CGI (indicative only)



Meeting room CGI (indicative only)

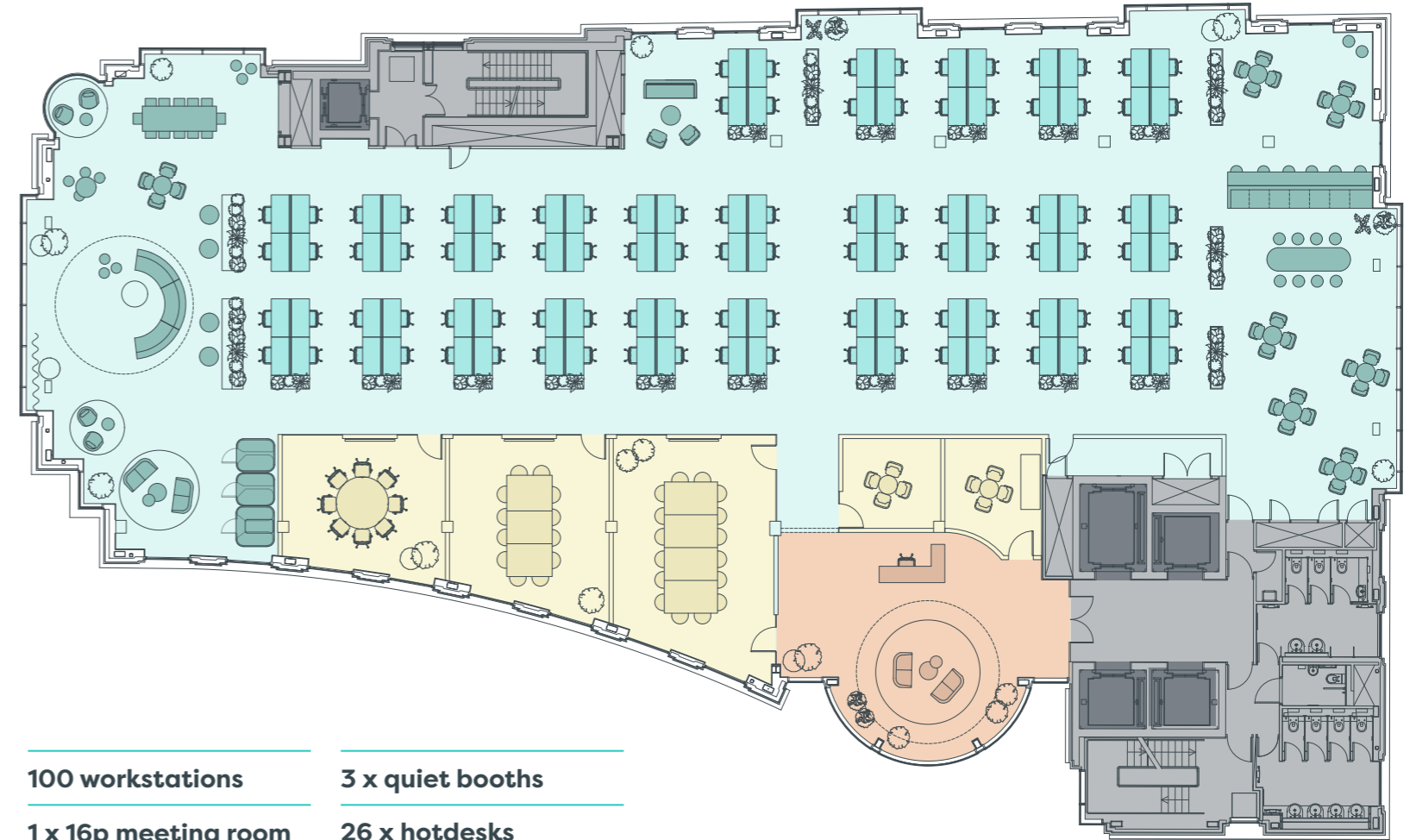

- Key**
- Office
 - Reception
 - Meeting rooms
 - Core
 - Lifts

- 100 workstations**
- 1 x 16p meeting room**
- 1 x 12p meeting room**
- 1 x 8p meeting room**
- 2 x 4p meeting room**
- 3 x quiet booths**
- 26 x hotdesks**
- Collaborative spaces**
- Break out areas**
- Entrance lobby**

Space plan not to scale.
For indicative purposes only.